

SCHEDULE OF PERMANENT AND REFERENCE MARKS

CNR.	BEARING	DIST.	FROM	ORIGIN
A	301° 06'	2.015	D.H. & WING	D.P. 703018
B	136° 21'	3.555	D.H. & WING	PLACED
C	170° 13'	1.00	D.H. & WING	PLACED
D	178° 55' 30"	0.285	D.H. & WING	D.P. 785730
E	38° 48'	0.39	G.I. ROD	D.P. 1142079
F	108° 22'	0.845	G.I. ROD	D.P. 1142079
G	279° 13' 25"	3.02	G.I.P.I.P.E.	D.P. 785730
	87° 47' 05"	19.605	SSM 52575	D.P. 1142079

MARK	MGA COORDINATES		CLASS	PU	METHOD	STATE
	EASTING	NORTHING				
SSM 52575	657980.288	6490269.204	C	N/A	SCMS	FOUND
PM 27211	658041.704	6490452.751	B	0.02	SCMS	FOUND
PM 27212	658111.148	6490541.493	B	N/A	SCMS	FOUND

DATE OF SCMS CO-ORDINATES 17-02-2020
COMBINED SCALE FACTOR 0.999860
MGA ZONE 55
MGA DATUM GDA2020

DIAGRAM 1 (NOT TO SCALE)

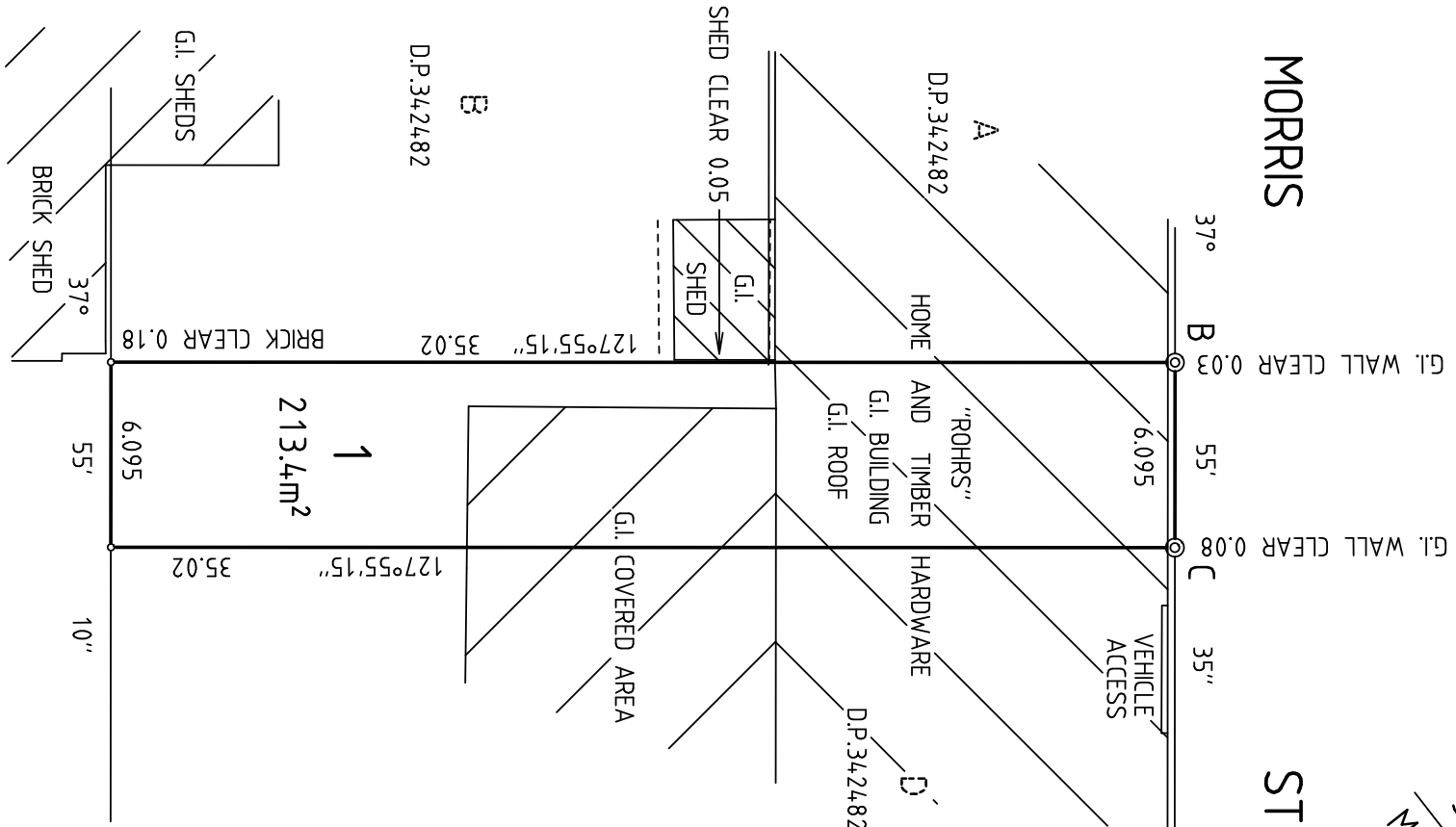

Surveyor: WAYNE KEITH ROWE
of LANGFORD & ROWE SURVEYORS, DUBBO.
Date of Survey: 18-02-2020
Surveyors Ref: 2019065A

PLAN OF TITLE CREATION AND ROAD CLOSING
UNDER THE ROADS ACT 1993 (COMPRISED IN
VOL.1208 FOL.128 & VOL.1343 FOL.243)

L.G.A. GILGANDRA
Locality: GILGANDRA
Reduction Ratio 1 : 250
Lengths are in metres.

10/07/2023

DP1295466

PLAN FORM 6 (2019)		DEPOSITED PLAN ADMINISTRATION SHEET	Sheet 1 of 3 sheet(s)
<p>Registered:  10/07/2023</p> <p>Title System: TORRENS</p>		<p>Office Use Only</p> <p>DP1295466</p>	
<p>PLAN OF FIRST TITLE CREATION AND ROAD CLOSURE UNDER THE ROADS ACT 1993. (COMPRISED IN VOL.1208 FOL. 108 + VOL.1343 FOL.243) 128</p>		<p>LGA: GILGANDRA Locality: GILGANDRA Parish: BOBARAH County: EWENMAR</p>	
<p>Survey Certificate</p> <p>I, WAYNE KEITH ROWE of LANGFORD & ROWE SURVEYORS, DUBBO a surveyor registered under the <i>Surveying and Spatial Information Act 2002</i>, certify that:</p> <p>*(a) The land shown in the plan was surveyed in accordance with the <i>Surveying and Spatial Information Regulation 2017</i>, is accurate and the survey was completed on 18/02/2020, or</p> <p>*(b) The part of the land shown in the plan ("being") was surveyed in accordance with the Surveying and Spatial Information Regulation 2017, the part surveyed is accurate and the survey was completed on 19-12-2019, the part not surveyed was compiled in accordance with that Regulation, or</p> <p>*(c) The land shown in this plan was compiled in accordance with the Surveying and Spatial Information Regulation 2017.</p> <p>Datum Line: SSM 52575 – PM 27211 SCIMS Type: *Urban /*Rural The terrain is *Level-Undulating / *Steep-Mountainous. Signature: <u>W. M. Rowe</u> Dated: <u>22/5/23</u> Surveyor Identification No: 1938 Surveyor registered under the <i>Surveying and Spatial Information Act 2002</i></p> <p>*Strike out inappropriate words. **Specify the land actually surveyed or specify any land shown in the plan that is not the subject of the survey.</p>		<p>Crown Lands NSW/Western Lands Office Approval</p> <p>I, (Authorised Officer) in approving this plan certify that all necessary approvals in regard to the allocation of the land shown herein have been given.</p> <p>Signature: Date: File Number: Office:</p> <p>*Strike through if inapplicable. Subdivision Certificate</p> <p>I, <u>DAVID NEEVES</u> *Authorised Person/*General Manager/*Accredited Certifier, certify that the provisions of s.6.15 of the <i>Environmental Planning and Assessment Act 1979</i> have been satisfied in relation to the proposed subdivision, new road or reserve set out herein.</p> <p>Signature: <u>[Signature]</u> Accreditation number: Consent Authority: <u>GILGANDRA SHAE COUNCIL</u> Date of endorsement: <u>23/5/23</u> Subdivision Certificate number: File number:</p>	
<p>Plans used in the preparation of survey/compilation. DP785730 DP1142079 DP703018</p>		<p>Statements of intention to dedicate public roads, create public reserves and drainage reserves, acquire/resume land.</p> <p>IT IS INTENDED TO CLOSE THE ROAD SHOWN AS LOT 1</p>	
<p>Surveyor's Reference: 2019065A</p>		<p>Signatures, Seals and Section 88B Statements should appear on PLAN FORM 6A</p>	

PLAN FORM 6A (2019)

DEPOSITED PLAN ADMINISTRATION SHEET

Sheet 2 of 3 sheet(s)



10/07/2023

Office Use Only

Office Use Only

Registered:

DP1295466

PLAN OF TITLE CREATION AND ROAD
CLOSING UNDER THE ROADS ACT 1993
(COMPRISED IN VOL.1208 FOL.108 &
VOL.1343 FOL.243). 128

This sheet is for the provision of the following information as required:

- A schedule of lots and addresses - See 60(c) *SSI Regulation 2017*
- Statements of intention to create and release affecting interests in accordance with section 88B *Conveyancing Act 1919*
- Signatures and seals- see 195D *Conveyancing Act 1919*
- Any information which cannot fit in the appropriate panel of sheet 1 of the administration sheets.

Subdivision Certificate number:

Date of Endorsement:

STREET ADDRESSES NOT KNOWN FOR NEW LOT

Gilgandra Shire Council by its authorized delegate pursuant to s.377 Local Government Act, 1993.

Signature of delegate:

Name of delegate: DAVID NEEVES

I certify that I am an eligible witness and that the delegate signed in my presence.

Signature of Witness:

Name of Witness: CHERYL TILLMAN

Address of Witness: 1309 HILLSIDE ROAD
CURBAN NSW 2827.

If space is insufficient use additional annexure sheet

Surveyor's Reference: 2019065A

PLAN FORM 6A (2019) DEPOSITED PLAN ADMINISTRATION SHEET

Sheet 3 of 3 sheet(s)

Registered:



10/07/2023

Office Use Only

Office Use Only

DP1295466

PLAN OF TITLE CREATION AND ROAD
CLOSURE UNDER THE ROADS ACT 1993
(COMPRISED IN VOL.1208 FOL. ~~108~~ &
VOL.1343 FOL.243). 128

Subdivision Certificate number:

Date of Endorsement:

This sheet is for the provision of the following information as required:

- A schedule of lots and addresses - See 60(c) *SSI Regulation 2017*
- Statements of intention to create and release affecting interests in accordance with section 88B *Conveyancing Act 1919*
- Signatures and seals- see 195D *Conveyancing Act 1919*
- Any information which cannot fit in the appropriate panel of sheet 1 of the administration sheets.

Certificate of Currency

I, WAYNE KEITH ROWE

Of LANGFORD AND ROWE CONSULTING SURVEYORS

a surveyor registered under the *Surveying and Spatial Information Act 2002*, certify that, from the date of the completion of the survey shown on the survey certificate:

- (a) there are no changes to the boundaries of the land to which the survey relates (the *subject land*), and the definition of those boundaries in the plan of survey remains consistent with surrounding plans, or if not, the plan of survey has been updated;
- (b) 2 or more of the permanent survey marks used in the survey remain in place, or if not, the plan of survey has been updated;
- (c) all reference marks placed in respect of the survey remain in place, or if not, the reference marks have been replaced and the plan of survey has been updated; and
- (d) there has been no change to the occupations and other improvements relevant to the boundaries of the subject land since the completion of the survey, or if not, the plan of survey has been updated.

Signature: W. M. Rowe Date: 22/5/2023

Surveyor Identification No.:SU001938.....

If space is insufficient use additional annexure sheet

Surveyor's Reference: 2019065A