

refer Gilgandra Council  
Infrastructure Team -  
Stormwater Drainage  
Plaza Sketch

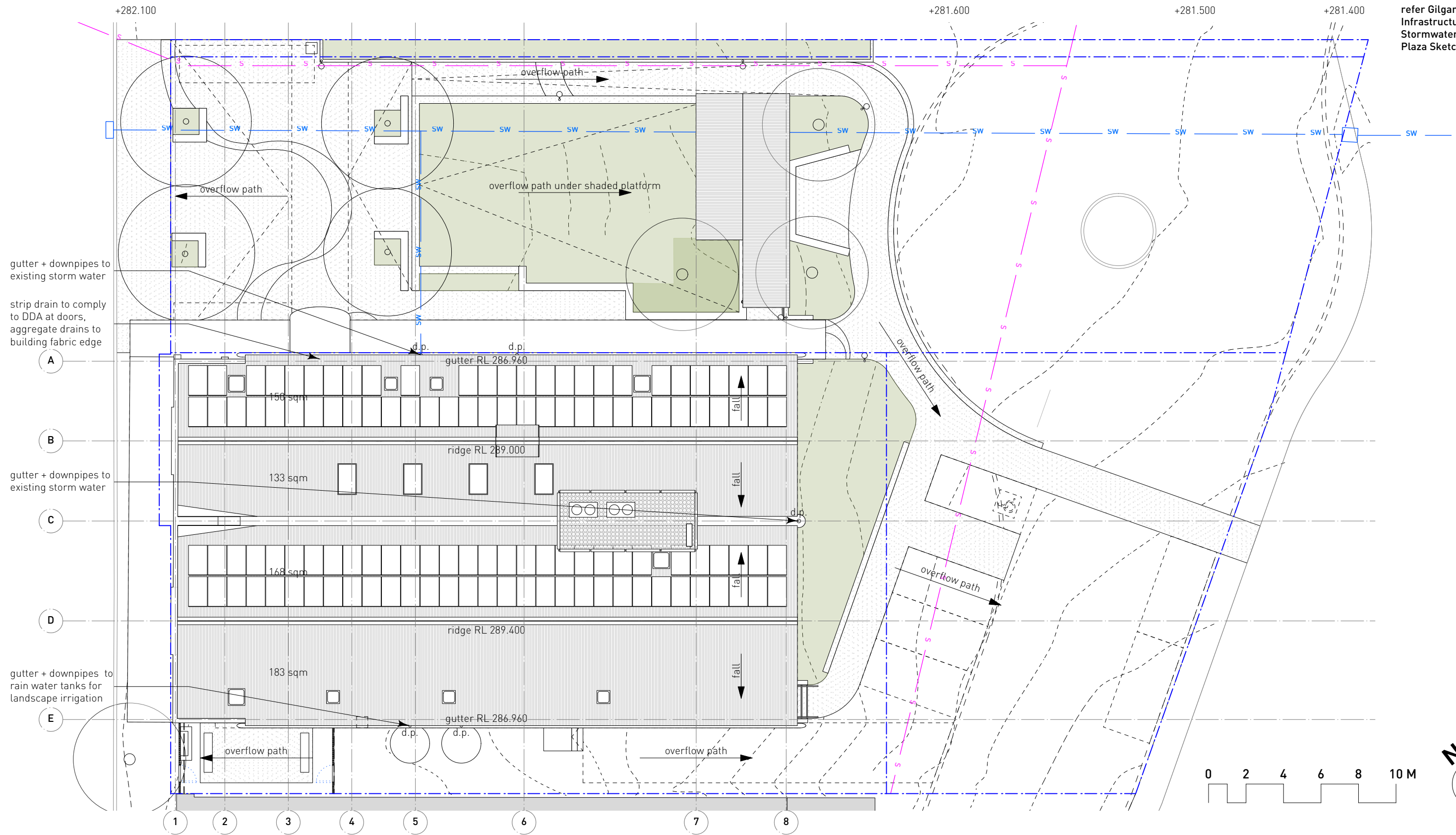

**DUNN & HILLAM**  
ARCHITECTS

Workshop 1 Pty Ltd  
t/a Dunn & Hillam Architects  
ACN 098 309 196 ABN 17 098 309 196  
Nominated architect Ashley Dunn NSW ARB No. 7547  
  
This drawing, the information and design  
in it are copyright to Workshop 1 Pty Ltd.

Revision	Note

33 Salisbury St, Botany NSW 2019  
T: +61 2 9316 7715 E: admin@dunnhillam.com.au W: dunnhillam.com.au

**Consultants**

Surveyor - Western Survey Pty Ltd  
contact ph: 0499 080 997

Structural Engineer - John Carrick Pty Ltd  
contact ph: 02 9698 2961

Services Engineer - JHA  
contact ph: 02 9437 1000

BCA/Access - Design Confidence  
contact ph: 02 8399 3707

Traffic - Lyle Marshall & Partners  
contact ph: 02 9436 0086

Quantity Surveyor - Altus Group  
contact ph: 02 9283 7311

Landscape Architect - Somewhere  
contact ph: 0428 695 706

**Notes**

1. all dimensions in mm.
2. do not scale from drawing.
3. this drawing has been prepared for Development Approval purposes only and is not to be used for tender or construction.
4. clarification to be sought from the architect in the event of any discrepancies in the documentation or if further information is required.

<b>Client</b>	Gilgandra Shire Council
<b>Project</b>	GIL Library Hub and Plaza 30-34 Miller Street, Gilgandra
<b>Issue</b>	Development Approval
<b>Date</b>	Fri, 11 Jun 2021
<b>Scale</b>	1:200 @A3
<b>Drawing</b>	Stormwater
<b>Dwg No.</b>	DA01-11
<b>Job No.</b>	20_304
<b>Drawn</b>	GY
<b>Rev.</b>	
<b>Check</b>	AD